

**INSU**  **FOX**

Substructure profiles with the best characteristics

# ENTER THE FOX LEVEL.

## TABLE OF CONTENTS

GARGIULO products .....	4
Introduction and design principle .....	6
Benefits and characteristics .....	9
Production processes .....	10
Best insulation performance .....	13
INSUFOX in practice.....	14
Sustainability .....	16
We are GARGIULO .....	18

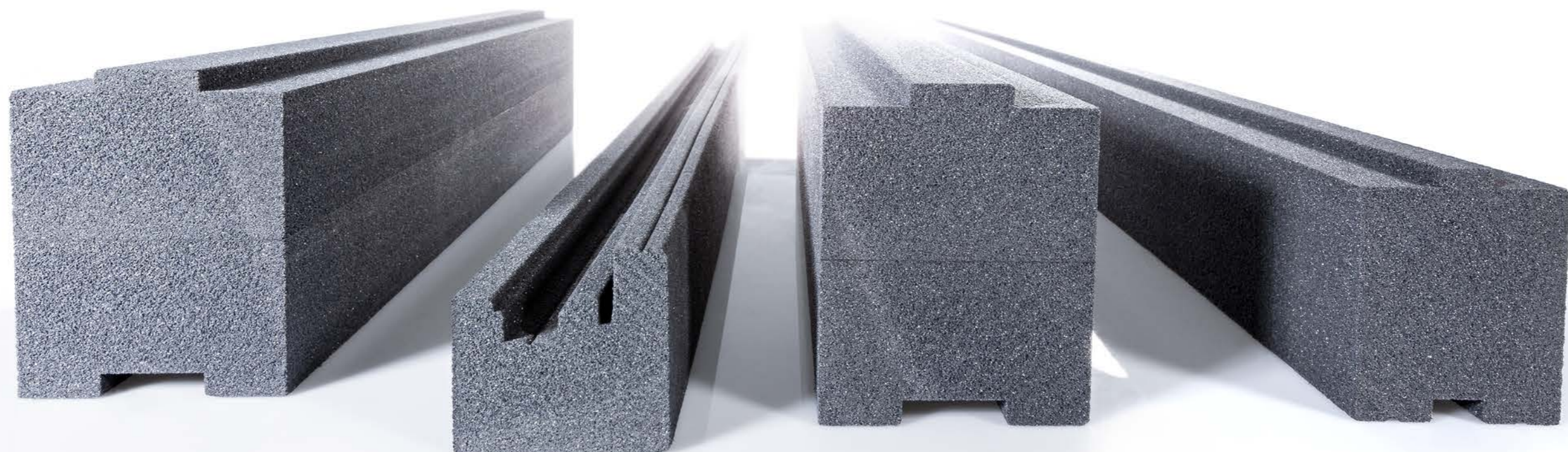



INSULATION

# GARGIULO PRODUCTS

We create thermal breaks made of PA and ABS, insulation foams made of PE/PET, PVC and ASA profiles, as well as our own PVC window systems in our production halls. We are also the perfect development partner for specific requirements and unusual projects with our own design and development department and our in-house toolmaking and jig construction.

Our advantage is maximum flexibility – both in planning and development as well as in our production processes. This enables us to meet the individual requirements of our customers at all times.

### WINDOW SYSTEMS

Made of PVC: Our WINGO profile series meets the high standards in terms of aesthetics, statics, sound and thermal insulation and when it comes to outstanding technology and safety.

### INSULATION FOAMS

Made of PE/HT foam, highly insulating, halogen-free, bio-based, resistant to high temperatures, also in combination with our thermal breaks, tailor-made.

### THERMAL BREAKS

Made of recycled PA or ABS, compatible with your window system, with or without finishing – solutions according to the customer's wishes.

### INSUFOX

Substructure profile made of PET, highly insulating, load-bearing construction material, individually adaptable contours.

### INSULATION FOAMS

Insulation foams for the lowest U-values

### THERMAL BREAKS

Thermal breaks for the highest requirements

### INSUFOX

Substructure profiles with the best characteristics for the lowest U-values

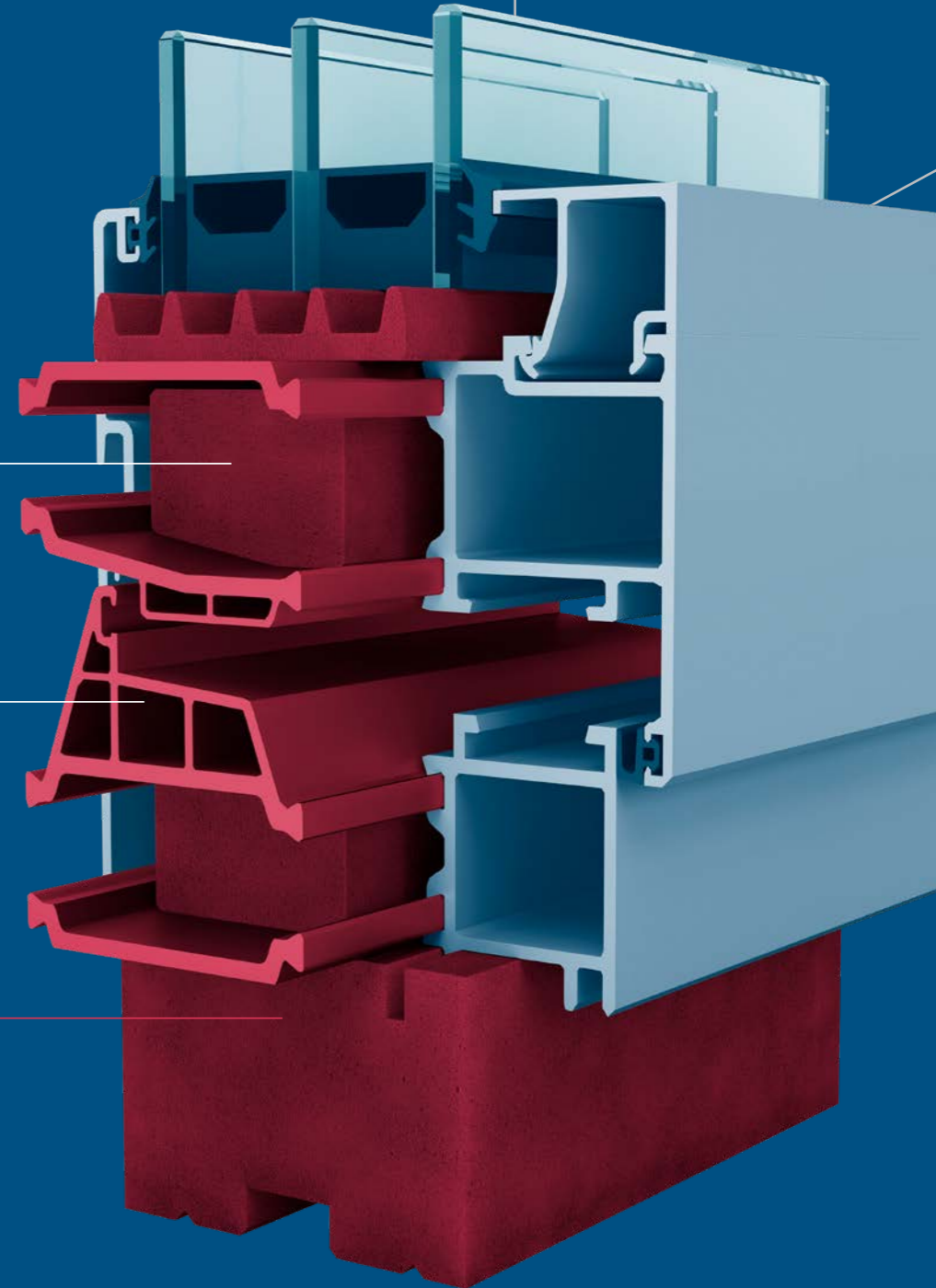



# INSUFOX

## PERFECT INTEGRATION INTO THE BUILDING STRUCTURE

A window, a door or a façade element is ultimately only as good as the respective integration into the building structure in terms of the U-value. Important details for the energy consumption are therefore found in the substructure.

In order to counteract any weak points in the insulation concept of buildings, such as thermal bridges through profiles, we use our own INSUFOX development as a substructure profile: a highly insulating, non-decomposable, high-temperature-resistant and extremely pressure-resistant construction material that can be mechanically processed without any problems.

It ensures optimum insulation performance and not only saves on energy and CO<sub>2</sub>, but also on waste and costs through waste-optimised work.

INSUFOX adapts to the respective profile requirements because of its sophisticated plug-in connection and is compatible with all systems thanks to appropriate adapter profiles.

INSUFOX is also CFC and HCFC-free and 100% recyclable!

System companies, fabricators, fittings distributors and manufacturers benefit in many ways from our modular profile structure.

# MAXIMUM MODULARITY

## THE PRACTICAL DESIGN PRINCIPLE

The INSUFOX substructure insulation profiles are variable in every respect – not only in terms of length due to the continuous production, but also in terms of installation depth (here: 50 mm) and above all with regard to the installation height.

They can be adapted vertically in the modular system almost in any way you wish because we produce them in different modular dimensions (here: 15 mm). The four standard heights (here: 15, 30, 45 and 60 mm) therefore permit any desired installation height in the respective combination without having to process elements separately.

Any adaptation to the respective profile system is carried out by means of a variable adapter profile.

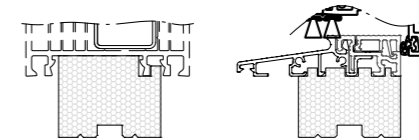
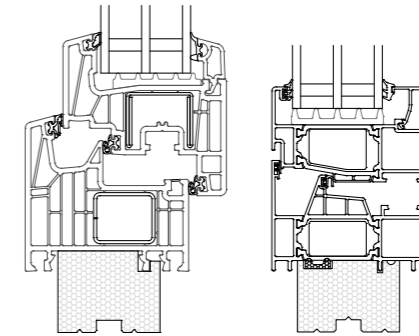

Adapter profile (system-specific)  
Example for an aluminium or brick windowsill

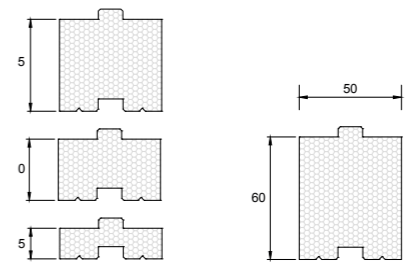

Substructure profiles with a modular dimension of 15 mm

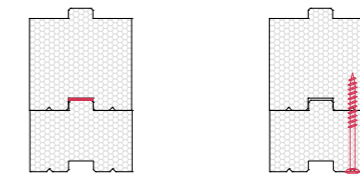

The product is installed in a practical tongue and groove system.  
If required, additional adhesive or screw connections can be used.

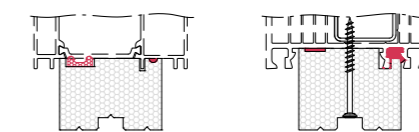

Maximum air tightness through sealing with self-adhesive PE foam profiles  
Adhesive tape or similar products as an installation aid and possible waterproofing with a suitable adhesive sealant

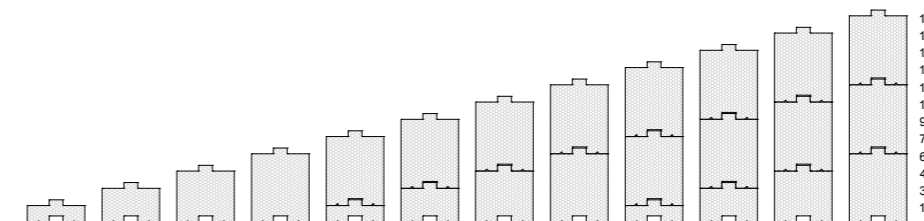

Sample installation height with a modular dimension of 15 mm

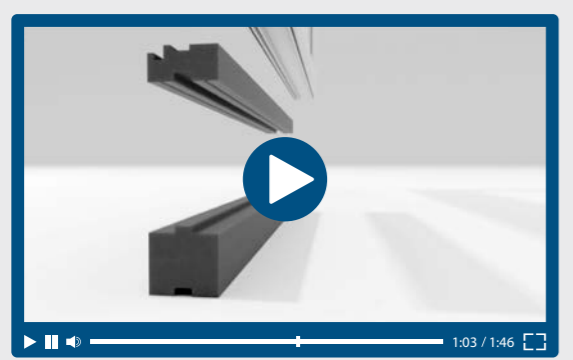
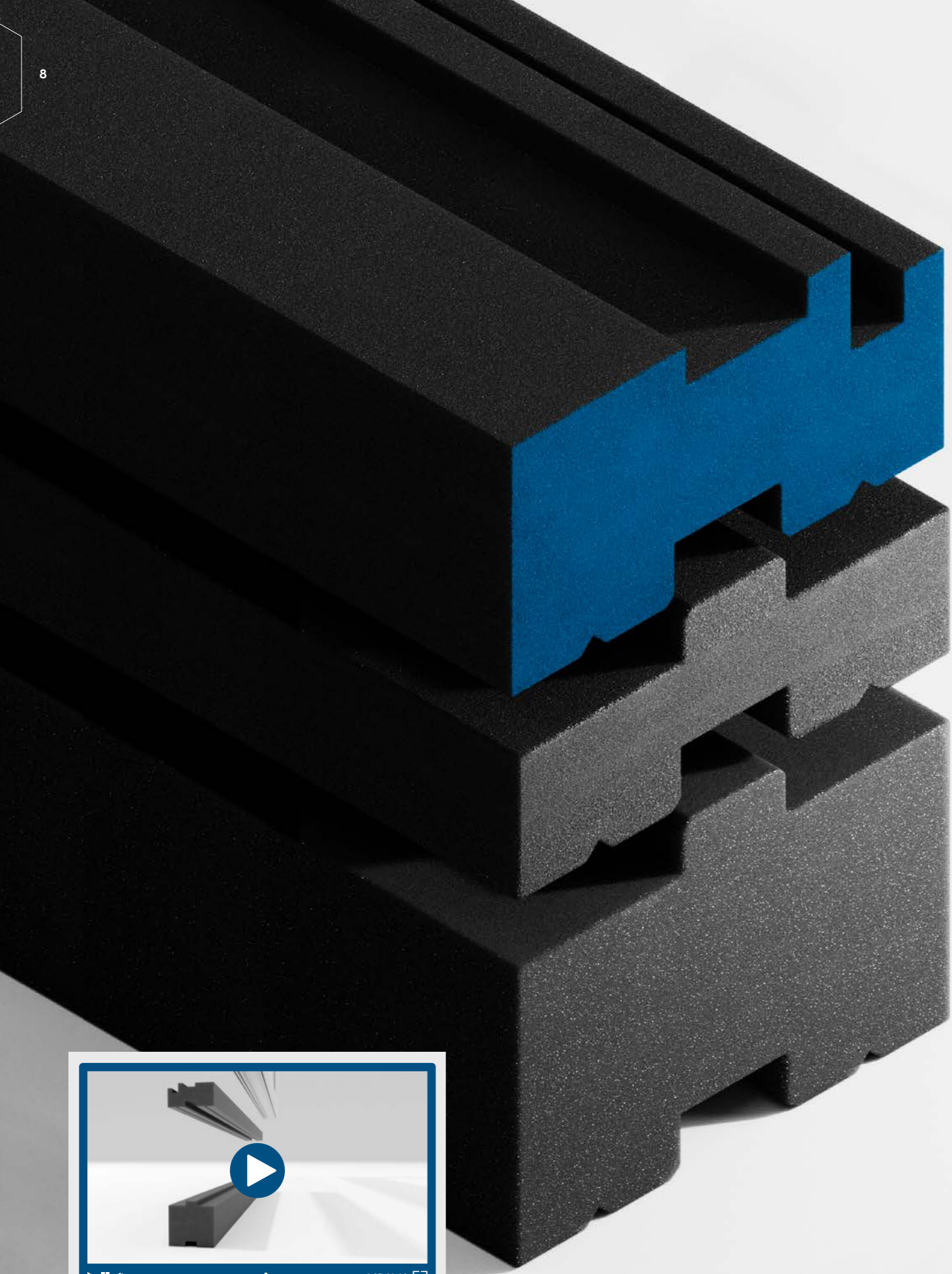

Experience INSUFOX in the video. Scan the QR code now!



# BENEFITS AND CHARACTERISTICS AT A GLANCE

**HIGHLY INSULATING** Highly insulating construction material for optimum insulation performance

**EXCELLENT SCREW WITHDRAWAL VALUES** for stable connections

**PRODUCIBLE IN ANY LENGTHS REQUIRED** for cut-optimised work and optimal transport and logistics processes (6.0 m standard)

**EASY CONNECTION** through welding

**COMPATIBLE WITH ALL SYSTEMS** thanks to the tailor-made adapter profile

**SIMPLE EXTENSION OF THE INSTALLATION HEIGHT** for easy height adjustment

**AVAILABLE IN RECYCLED PLASTIC** for resource-friendly production

**OUTSTANDING TEMPERATURE RESISTANCE** from -40 °C to +200 °C

**PRACTICAL INSTALLATION AID** using hot-melt adhesive

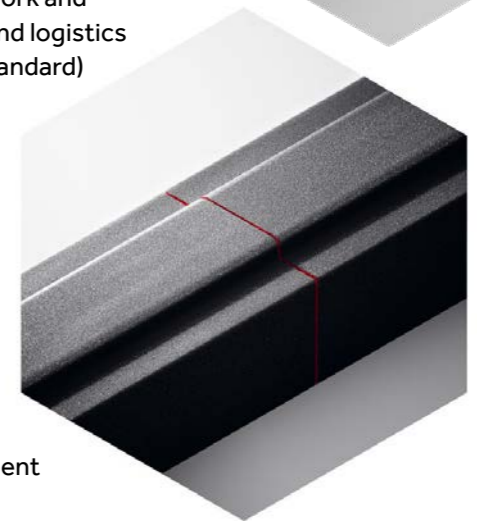
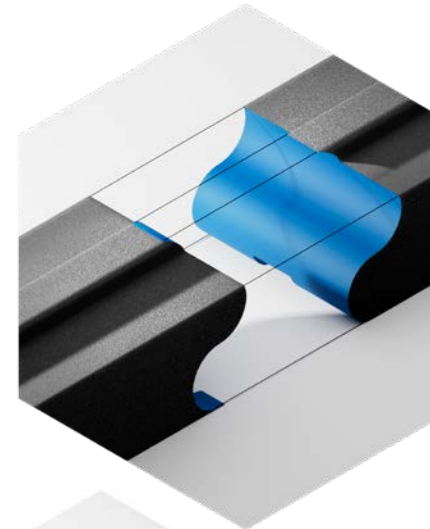

# PRODUCTION PROCESSES

## FROM RAW MATERIALS TO HIGH-PERFORMANCE MATERIALS

Our special formulation, selection of highly effective additives and our unique production process give our INSUFOX substructure profiles their outstanding characteristics – confirmed by all testing and certification bodies.

Thanks to our patented cutting process or precise milling, our tongue and groove substructure profiles, uniform surfaces, rough surface texture and sharp contours are created from large extruded insulation blocks.

Our customers decide whether we produce continuously, cut our in-house standard measurements to length or follow specific measurement specifications.



With INSUFOX, we have created a construction material that enables a wide range of applications: From the milling of complex geometries to special constructions with partitions, undercuts or air chambers, everything is possible.

INSUFOX –  
**THE STRONGEST**  
 THAT A FOAM CAN BE.



**0.043**  
LAMBDA

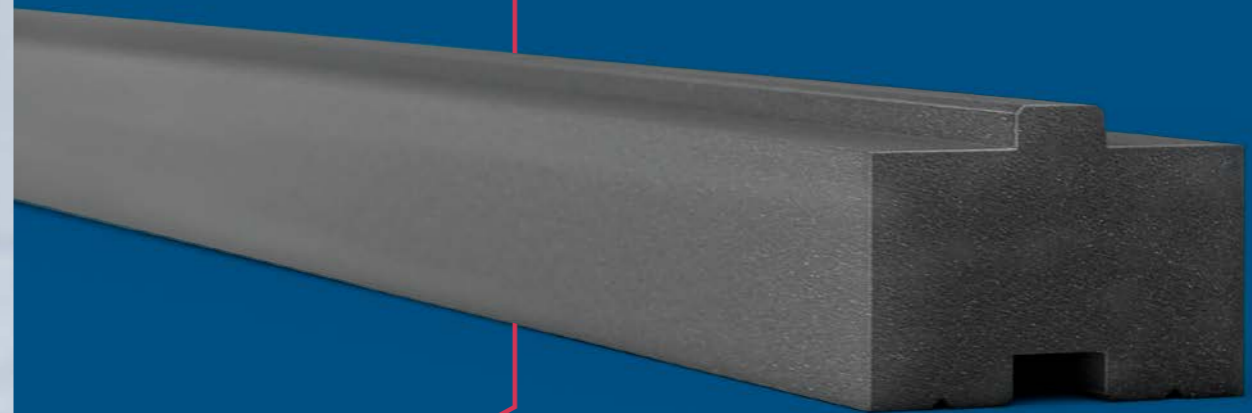

## U-VALUE OPTIMISATION WITH INSUFOX

### BEST INSULATION CHARACTERISTICS FOR THE LOWEST U-VALUES

A window or door does not end at the frame from an energy point of view. The integration of the components into the building structure must be taken into account and included in the determination of the U-values.

Substructure insulation profiles make an important contribution here and can lead to improved U-values. In order to achieve the best U-value when combined, all components must have the lowest possible individual values ( $U_f$  and  $U_w$ ).

Standard PVC substructure profiles have a lambda value of 0.170. This is the weak point in terms of insulation. This can be fixed with our INSUFOX:

The unique formulation of the PET foam, which makes up our substructure insulation profiles, permits an extremely low lambda value of 0.043! INSUFOX therefore helps to reduce the U-values even more noticeably.

# INSUFOX IN PRACTICE

Large windows, sliding glass doors or glass façades, as shown in the photo, harbour the risk of high heat losses and can significantly increase heating and cooling costs.

This is where INSUFOX comes into play:

The clever modular system with matching adapter profiles easily adapts to the respective profile requirements.

Thanks to continuous production, our substructure profiles, which are available in any length, are extremely easy to handle - and therefore enable waste-optimised work.







Many say that only renunciation will help retain our planet's appeal. We say: "There's more to it!"

# WHAT DOES SUSTAINABILITY MEAN FOR GARGIULO?

## A KEY TOPIC IN THE CORPORATE STRATEGY

For us, sustainability is more than resource conservation and CO<sub>2</sub> reduction – it is a central component of our corporate strategy. Our innovative products actively contribute to sustainable living and create buildings that combine the environment and quality of life. Here we think beyond pure environmental protection: Our goal is to meet today's needs without jeopardising the opportunities of future generations.

### MORE RESPONSIBILITY = MORE QUALITY

A key part of GARGIULO's sustainability strategy is an active integrated management system for quality, energy and the environment – from raw material procurement and production to logistics and waste disposal. To be able to offer high-quality and individual products, GARGIULO sets high quality standards – for employees, work processes, materials and production facilities. All products naturally meet the special national and international standards, such as RAL in Germany, CSTB in France and ATG in Belgium. We ensure the highest quality standards with our production that is carried out almost completely in-house. 24/7 monitoring and strict testing in our own laboratory guarantee standard-compliant products. Our quality management system has been ISO 9001:2015 certified since 2017 and has been continuously improved since then. The main goal here is to ensure the highest standards with all products and services in all departments and processes. This not only prevents errors, but also ensures continuous improvement in all products and processes. The development of innovative, sustainable products that make a decisive contribution to the environment and climate protection with the highest quality and environmental standards is particularly important to us.

### MORE ENERGY EFFICIENCY

GARGIULO introduced its own energy management system in 2013 in order to identify potential savings and to improve energy efficiency in the long term. In 2014, the system was successfully certified in accordance with ISO 50001. In this way, we make an important contribution to environmental protection and are also involved in regional energy-saving projects.

### MORE ENVIRONMENTAL AWARENESS

In order to improve environmental protection, GARGIULO introduced an environmental management system in 2017 and had it certified in accordance with ISO 14001. National and statutory requirements are considered the minimum standard. All products are tested for their entire life cycle in order to optimally recycle valuable raw materials. We rely on recyclable materials and almost 100% recyclability through our own recycling mills.

### MORE POWER

Our photovoltaic systems together generate an impressive 2 megawatts of clean electricity at two locations, making a valuable contribution to the energy transition. With state-of-the-art photovoltaic technology, we focus on maximum efficiency and sustainability – for a climate-friendly future.

## OUR INSUFOX

### HAS THE FOLLOWING SUSTAINABILITY CHARACTERISTICS:

- Recycled PET
  - Certified carbon footprint
- Halogen-free PET
  - Cradle to Cradle Certificate SILVER – NEW 2025

### OUR CERTIFICATION PARTNERS



# WE ARE GARGIULO

We are specialists in profile production and in the development of individual customer solutions. A total area of approximately 80,000 m<sup>2</sup> offers sufficient space for more than 80 production lines as well as for the storage, picking and development of plastic profiles.

Our production sites are located exclusively in Germany in the heart of Baden-Württemberg, well-known for German engineering and innovation. We combine decades of experience, precise production and the highest quality standards – “made in Germany”.

From intelligent profile technology with excellent insulation values (INSULATION) and complex systems (SYSTEMS) to the constant development of new processes, materials and systems for greater efficiency and sustainability (MOVES) – we are the right partner!



INSULATION

Our thermal breaks for window and façade systems are largely responsible for higher insulation values.



SYSTEMS

We are both a complete supplier of extrusion solutions and a producer of our own profile and window systems.



MOVES

As visionaries and inventors with passion, we are always on the move and are constantly working on new solutions and technologies.



## Approx. 80,000 m<sup>2</sup>

Total area available for the production, storage, picking and development of plastic profiles.

## 80 production lines

produce thermal breaks (PA + ABS), insulation foams (PE + PET), profiles (PVC + ASA) and our own PVC window systems.

## More than 60 extruders

run simultaneously in all plants and guarantee on-time production with high output rates.

## More than 12,000 tons

of raw materials (approx. 500 truck loads) are processed each year. This figure underlines our performance.

## 630 million metres of profiles

have been produced in the last 30 years. In whole, this length corresponds to almost 16 times the circumference of the earth.

## 180 employees

with 20 different nationalities. 13 of them have over 20 years of service with the company. Their average age is 42 years old.

## WOULD YOU LIKE TO KNOW MORE ABOUT OUR PRODUCT PORTFOLIO OR OUR MATERIALS?

**DROP US A LINE – WE LOOK FORWARD TO RECEIVING  
YOUR MESSAGE!**

**Your contact:**

Marcus Müller  
vertrieb@gargiulo.de



**GARGIULO GMBH**

Daimlerstr. 21 | 72147 Nehren | Germany

Tel.: +49 7473 9438-0

Fax: +49 7473 9438-250

Email: [info@gargiulo.de](mailto:info@gargiulo.de)

[www.gargiulo.de](http://www.gargiulo.de)

**MADE  
IN  
GERMANY**

GARGIULO is a German company  
based in Baden-Württemberg,  
producing exclusively in Germany.

